

定位珠螺絲·無頭，附細螺紋 EH 22720.



產品描述

也可用來定位、鉗緊、繃緊和支撐表面使之無法完全平行。
細牙螺紋允許精確調整。
最大荷載傳遞因為可移動的球體。

材質

珠子

- 軸承鋼，硬化
- 不鏽鋼，硬化

螺絲

- 鋼，熱處理， $1200 \pm 100 \text{ N/mm}^2$
- 不鏽鋼 1.4305

更多資訊

注意事項

珠子無防止旋轉功能。
特殊的樣式歡迎洽詢。

參考

需求的螺紋鎖，請參閱附錄 - 技術數據 -

更多產品

- 定位珠螺絲，無頭，球防止迴轉
- 定位珠螺絲，無頭，圓球
- 定位珠螺絲，無頭，有平面的球

圖面

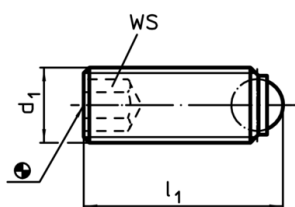

picture 1

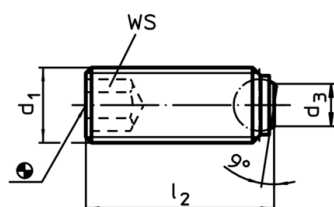

picture 2

訂單資訊

d ₁	尺寸		d ₃	球直徑	WS [mm]	靜態荷 重能力 ¹⁾ max. [kN]	max. [°C]	[g]	RoHS	REACH	品號
	l ₁	l ₂									
圓珠子，鋼或不鏽鋼 (相片1) – 相片1, 熱處理鋼											
M4 x 0,35	6,0	-	-	2,5	2,0	3,5	250	0,4	RoHS 認證	contains SVHC materials >0.1% w/w	22720.5030
M4 x 0,35	10,0	-	-	2,5	2,0	3,5	250	0,8	RoHS 認證	contains SVHC materials >0.1% w/w	22720.5032
M4 x 0,5	6,0	-	-	2,5	2,0	3,5	250	0,4	RoHS 認證	contains SVHC materials >0.1% w/w	22720.5040
M4 x 0,5	10,0	-	-	2,5	2,0	3,5	250	0,8	RoHS 認證	contains SVHC materials >0.1% w/w	22720.5042
M5 x 0,5	8,0	-	-	3,0	2,5	4,5	250	0,7	RoHS 認證	contains SVHC materials >0.1% w/w	22720.5050
M5 x 0,5	12,0	-	-	3,0	2,5	4,5	250	1,2	RoHS 認證	contains SVHC materials >0.1% w/w	22720.5052
M6 x 0,5	10,8	-	-	4,0	3,0	9,0	250	1,3	RoHS 認證	contains SVHC materials >0.1% w/w	22720.5060
M6 x 0,5	12,8	-	-	4,0	3,0	9,0	250	1,8	RoHS 認證	contains SVHC materials >0.1% w/w	22720.5061

¹⁾ *荷重能力報告書不適用於不銹鋼

d ₁	尺寸				WS [mm]	靜態荷 重能力 ¹⁾ max. [kN]	🌡️ max. [°C]	📦 [g]	RoHS	REACH	品號
	l ₁	l ₂	d ₃	球直徑							
[mm]											
M6 x 0,5	16,8	-	-	4,0	3,0	9,0	250	2,4	RoHS 認證	contains SVHC materials >0.1% w/w	22720.5062
M6 x 0,5	20,8	-	-	4,0	3,0	9,0	250	3,0	RoHS 認證	contains SVHC materials >0.1% w/w	22720.5063
M6 x 0,5	25,8	-	-	4,0	3,0	9,0	250	3,0	RoHS 認證	contains SVHC materials >0.1% w/w	22720.5064
M8 x 1	11,2	-	-	5,5	4,0	15,0	250	2,6	RoHS 認證	contains SVHC materials >0.1% w/w	22720.5070
M8 x 1	21,2	-	-	5,5	4,0	15,0	250	5,4	RoHS 認證	contains SVHC materials >0.1% w/w	22720.5073
上標準夾持額 (相片1) – 相片 2, 熱處理鋼											
M4 x 0,35	-	5,6	1,3	2,5	2,0	3,5	250	0,4	RoHS 認證	contains SVHC materials >0.1% w/w	22720.5230
M4 x 0,35	-	9,6	1,3	2,5	2,0	3,5	250	0,8	RoHS 認證	contains SVHC materials >0.1% w/w	22720.5232
M4 x 0,5	-	5,6	1,3	2,5	2,0	3,5	250	0,4	RoHS 認證	contains SVHC materials >0.1% w/w	22720.5240
M4 x 0,5	-	9,6	1,3	2,5	2,0	3,5	250	0,8	RoHS 認證	contains SVHC materials >0.1% w/w	22720.5242
M5 x 0,5	-	7,5	2,2	3,0	2,5	4,5	250	0,7	RoHS 認證	contains SVHC materials >0.1% w/w	22720.5250
M5 x 0,5	-	11,5	2,2	3,0	2,5	4,5	250	1,2	RoHS 認證	contains SVHC materials >0.1% w/w	22720.5252
M6 x 0,5	-	10,0	3,2	4,0	3,0	9,0	250	1,3	RoHS 認證	contains SVHC materials >0.1% w/w	22720.5260
M6 x 0,5	-	12,0	3,2	4,0	3,0	9,0	250	1,8	RoHS 認證	contains SVHC materials >0.1% w/w	22720.5261
M6 x 0,5	-	16,0	3,2	4,0	3,0	9,0	250	2,4	RoHS 認證	contains SVHC materials >0.1% w/w	22720.5262
M6 x 0,5	-	20,0	3,2	4,0	3,0	9,0	250	3,0	RoHS 認證	contains SVHC materials >0.1% w/w	22720.5263
M6 x 0,5	-	25,0	3,2	4,0	3,0	9,0	250	3,0	RoHS 認證	contains SVHC materials >0.1% w/w	22720.5264
M8 x 1	-	10,0	4,5	5,5	4,0	15,0	250	2,6	RoHS 認證	contains SVHC materials >0.1% w/w	22720.5270
M8 x 1	-	20,0	4,5	5,5	4,0	15,0	250	5,3	RoHS 認證	contains SVHC materials >0.1% w/w	22720.5273
圓珠子, 鋼或不鏽鋼 (相片1) – 相片 1, 不鏽鋼											
M4 x 0,35	6,0	-	-	2,5	2,0	3,5	250	0,4	RoHS 認證	contains no SVHC materials	22720.6030
M4 x 0,35	10,0	-	-	2,5	2,0	3,5	250	0,8	RoHS 認證	contains no SVHC materials	22720.6032
M4 x 0,5	6,0	-	-	2,5	2,0	3,5	250	0,4	RoHS 認證	contains no SVHC materials	22720.6040
M4 x 0,5	10,0	-	-	2,5	2,0	3,5	250	0,8	RoHS 認證	contains no SVHC materials	22720.6042

¹⁾*荷重能力報告書不適用於不鏽鋼

d ₁	尺寸				WS [mm]	靜態荷 重能力 ¹⁾ max. [kN]	🌡️ max. [°C]	📦 [g]	RoHS	REACH	品號
	l ₁	l ₂	d ₃	球直徑							
[mm]											
M5 x 0,5	8,0	-	-	3,0	2,5	4,5	250	0,7	RoHS 認證	contains no SVHC materials	22720.6050
M5 x 0,5	12,0	-	-	3,0	2,5	4,5	250	1,2	RoHS 認證	contains no SVHC materials	22720.6052
M6 x 0,5	10,8	-	-	4,0	3,0	9,0	250	1,3	RoHS 認證	contains no SVHC materials	22720.6060
M6 x 0,5	12,8	-	-	4,0	3,0	9,0	250	1,8	RoHS 認證	contains no SVHC materials	22720.6061
M6 x 0,5	16,8	-	-	4,0	3,0	9,0	250	2,4	RoHS 認證	contains no SVHC materials	22720.6062
M6 x 0,5	20,8	-	-	4,0	3,0	9,0	250	3,0	RoHS 認證	contains no SVHC materials	22720.6063
M6 x 0,5	25,8	-	-	4,0	3,0	9,0	250	3,0	RoHS 認證	contains no SVHC materials	22720.6064
M8 x 1	11,2	-	-	5,5	4,0	15,0	250	2,6	RoHS 認證	contains no SVHC materials	22720.6070
M8 x 1	21,2	-	-	5,5	4,0	15,0	250	5,4	RoHS 認證	contains no SVHC materials	22720.6073
上標準夾持頸 (相片1) – 相片 2, 不銹鋼											
M4 x 0,35	-	5,6	1,3	2,5	2,0	3,5	250	0,4	RoHS 認證	contains no SVHC materials	22720.6230
M4 x 0,35	-	9,6	1,3	2,5	2,0	3,5	250	0,8	RoHS 認證	contains no SVHC materials	22720.6232
M4 x 0,5	-	5,6	1,3	2,5	2,0	3,5	250	0,4	RoHS 認證	contains no SVHC materials	22720.6240
M4 x 0,5	-	9,6	1,3	2,5	2,0	3,5	250	0,8	RoHS 認證	contains no SVHC materials	22720.6242
M5 x 0,5	-	7,5	2,2	3,0	2,5	4,5	250	0,7	RoHS 認證	contains no SVHC materials	22720.6250
M5 x 0,5	-	11,5	2,2	3,0	2,5	4,5	250	1,2	RoHS 認證	contains no SVHC materials	22720.6252
M6 x 0,5	-	10,0	3,2	4,0	3,0	9,0	250	1,3	RoHS 認證	contains no SVHC materials	22720.6260
M6 x 0,5	-	12,0	3,2	4,0	3,0	9,0	250	1,8	RoHS 認證	contains no SVHC materials	22720.6261
M6 x 0,5	-	16,0	3,2	4,0	3,0	9,0	250	2,4	RoHS 認證	contains no SVHC materials	22720.6262
M6 x 0,5	-	20,0	3,2	4,0	3,0	9,0	250	3,0	RoHS 認證	contains no SVHC materials	22720.6263
M6 x 0,5	-	25,0	3,2	4,0	3,0	9,0	250	3,0	RoHS 認證	contains no SVHC materials	22720.6264
M8 x 1	-	10,0	4,5	5,5	4,0	15,0	250	2,6	RoHS 認證	contains no SVHC materials	22720.6270
M8 x 1	-	20,0	4,5	5,5	4,0	15,0	250	5,3	RoHS 認證	contains no SVHC materials	22720.6273

¹⁾ *荷重能力報告書不適用於不銹鋼

應用範例

